

Project Title : SITE PLAN FOR LUCC

SITE PLAN SHOWING THE LAND OF PROPOSED GROUND (PARTLY PARKING, SHOP & FLAT) + 3 STD. RESIDENTIAL CUM COMMERCIAL BUILDING AT JANTA NAGAR, NEAR VETERINARY HOSPITAL, NABIN SEN ROAD, SILIGURI, DIST. - DARJEELING

LAND AREA AS PER DEED	973.91 SQ.M.
LAND AREA AS PER SITE	865.02 SQ.M.
PERM. GROUND COVERAGE	50 % OR 432.51 SQ.M.
PROP. GROUND COVERAGE	49.99% OR 432.48 SQ.M.
USE OF PROP. BUILDING	RESIDENTIAL CUM COMMERCIAL

LAND SCHEDULE	NAME OF OWNERS
MOUZA - SILIGURI	1) SMT. BABITA DEVI AGARWAL
PLOT NO - 8486 (R.S.)	W/O - SRI. ASHOK KUMAR AGARWALA
J. L. NO. - 110 (88)	
KHATIAN NO. - 2395 (R.S.)	2) SMT. ANITA AGARWALA
SHEET NO. - 14	W/O - SRI. BINOD KUMAR AGARWALA
W/O. - 10 (S.M.C.)	3) SRI. JITENDRA AGARWAL
PARAGANA - BAIKUNTHAPUR	S/O - LATE MOHAN LAL AGARWAL
P. S. - SILIGURI	4) SMT. INDRA DEVI MITRUKA
DIST. - DARJEELING	W/O - JAGDISH PRASAD MITRUKA
	5) SRI. JAGDISH PRASAD AGARWALA (MITRUKA)
	S/O - LATE DAL CHAND AGARWALA

DECLARATION -
WE SHALL MAINTAIN 2.5 M. AS OPEN SPACE AND NOT EVEN CONSTRUCT ANY STAIR IN THE SAID OPEN SPACE.

FLOOR	COMMERCIAL	RESIDENTIAL	PARKING	STAIR, LIFT & SERVICE	TOTAL AREA	REMARKS
GROUND	172.25 SQ.M.	59.46 SQ.M.	166.92 SQ.M.	33.85 SQ.M.	432.48 SQ.M.	COMMERCIAL (MERC./RETAIL) CAR PARKING RESIDENTIAL
FIRST		398.63 SQ.M.		33.85 SQ.M.	432.48 SQ.M.	RESIDENTIAL
SECOND		398.63 SQ.M.		33.85 SQ.M.	432.48 SQ.M.	RESIDENTIAL
THIRD		398.63 SQ.M.		33.85 SQ.M.	432.48 SQ.M.	RESIDENTIAL
TOTAL	172.25 SQ.M.	1255.35 SQ.M.	166.92 SQ.M.	135.4 SQ.M.	1729.92 SQ.M.	

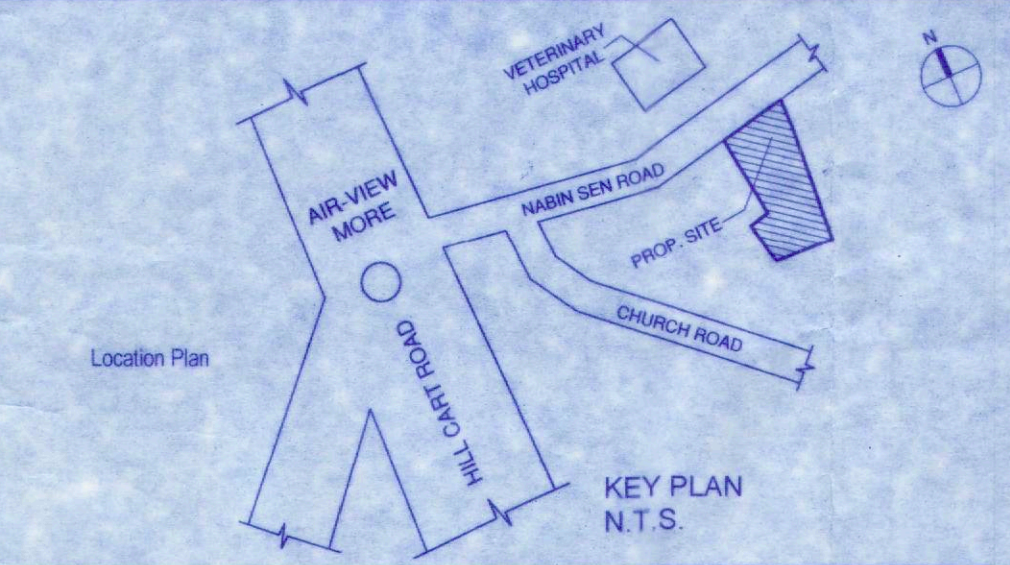

Jagdish Prasad Aggarwal
কৃষ্ণা হাল মিত্র
Anita Aggarwal
Babita Aggarwal
Jitendra Aggarwal

Er. Subrata Majumder
Licensed Building Surveyor Class - I
S.M.C. Empanelment Number - 73
S.S. Colony, Slg - 4, Mob.No - 9832062034/9933575581
E-Mail.ID - subratavilengineer@gmail.com

SIGNATURE OF OWNER

SIGNATURE OF L.B.S./L.B.A.

<p>Majumder & Associates Cont. - +91-9832062034, +91-9933575581</p>		<p>TITLE - SITE PLAN</p>	
DRAWN	SOURAV	SCALE	AS SHOWN
CHKD.	S. M.	SHEET NO.	01/01

AREA STATEMENT: SILIGURI	VERSION NO: 1.0.1		
JALPAIGURI DEVELOPMENT AUTHORITY	VERSION DATE: 30/08/2017		
PROJECT DETAIL			
Application No. -	Plot Use - Residential		
Application Type - General Proposal	Plot SubUse - Residential Bldg		
Project Type - LUCC	Land Use Zone - Residential		
Nature of Development - New	Abutting Road Width - 5.9		
Location - Siliguri Urban Area	Plot No. - 8486 RS		
SubLocation - Siliguri (M)	Sheet No. -		
Special Project Type - NA	House No. -		
Ward No - 10	North - 110(B)		
Name of Street - NA	South - SILIGURI		
Village Name - siliguri	East -		
	West -		
AREA DETAILS			
AREA OF PLOT (Minimum)	(A)	SQ.MT	865.02
NET AREA OF PLOT	(A-Deductions)		865.02
PLOT AREA FOR COVERAGE	(A-Deductions)		865.02
Plot Area for FAR	(A-Deductions)		865.02
COVERAGE CHECK			
Proposed Coverage Area (50.00 %)			432.48
Proposed Ground Coverage Area (50.00 %)			432.48
Total Prop. Coverage Area (50.00 %)			432.48
FAR CHECK			
BUILT UP AREA CHECK			
Total BuiltUp Area			0.00
ARCH/ENGG/SUPERVISOR (Regd)		OWNER	
DEVELOPMENT AUTHORITY		LOCAL BODY	
COLOR INDEX			
PLOT BOUNDARY			
ABUTTING ROAD			
PROPOSED WORK (COVERAGE AREA)			
EXISTING (To be retained)			
EXISTING (To be demolished)			

Color Index:

MARGIN DETAIL:

Building / Wing Name	Road Name	Front Margin	Ground Pwork Front Margin	Rear Margin	Ground Pwork Rear Margin	Side1 Margin	Ground Pwork Side1 Margin	Side2 Margin	Ground Pwork Side2 Margin
PROPOSED BUILDING	5.9 M. WIDE ROAD	4.55	4.55	3.04	3.04	1.23	1.23	3.95	3.95